

# Dailey Engineering Pressure Regulator Parts

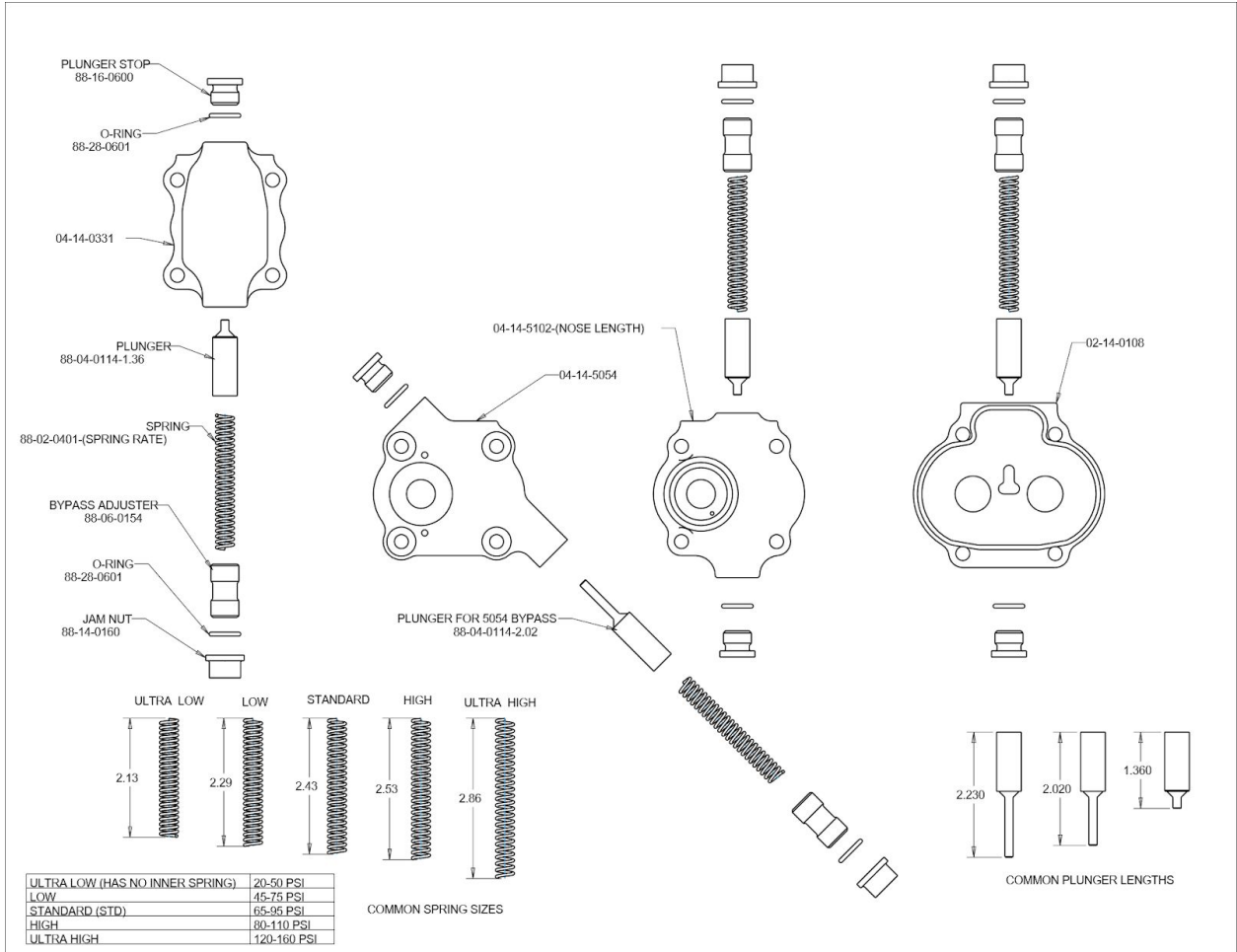

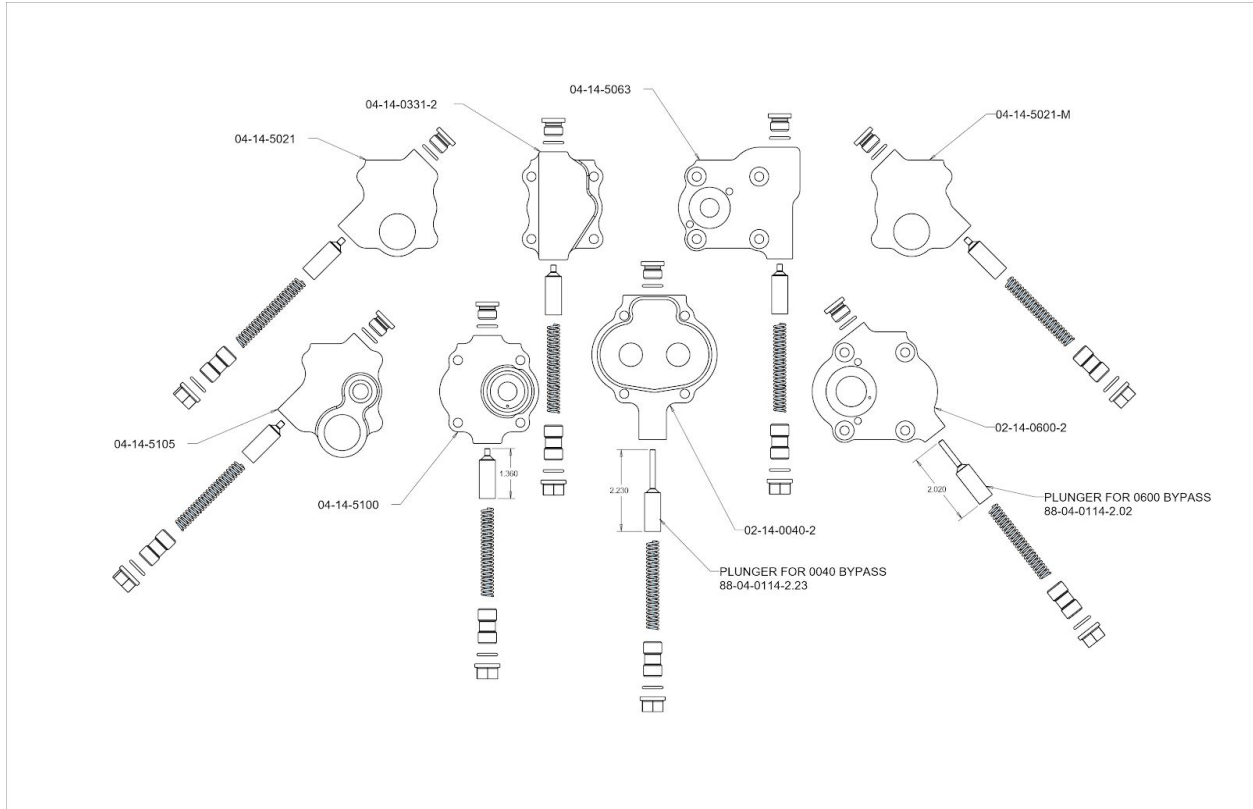

**To adjust RPM oil pressure you will need to first loosen the jam nut with a 9/16" wrench then with a 1/4" allen wrench you will be able to turn the adjustment screw. Each turn of the adjustment screw will change the pressure approximately 7 psi at the pump outlet.**

**(Turn the adjuster screw clockwise (Max 2 turns from flush) to increase pressure and counterclockwise (Max 3 turns from flush) to decrease pressure.)**

**\*NOTE\* This will only change the oil pressure at RPM, not idle.**

